



Acme Sanitary Ware Co Ltd

Acme Building, 22-28 Nanking Street, Kowloon, Hong Kong
 Tel: 2388 7171 Fax: 2710 8012
 E-mail: acme@acmesanitary.com.hk
 Website: www.acmesanitaryware.com.hk

PART OF **LIXIL**



PROJECT		REF		REV	ITEM CODE	
LOCATION		DATE			PAGE	

SANITARY WARE SPECIFICATION SHEET

Item Descriptions	GROHE (Germany) "BauEdge" Chrome plated single-lever basin mixer S-Size ;with side pop-up waste nominated flow rate 4.8 L/min in WELS Grade 1 ; Registration No. TM 17-0197	Illustration/ Drawing	
Dimensions	Height: 178 mm		
Model	23559000		
Material	Chrome Plated		
Country of Origin	Thailand		
Manufacturer	GROHE Limited		
Supplier	Acme Sanitary Ware Co. Ltd Mr. Eric Wong/ Mr. Don Yuen		
Contact Tel/Fax	(852) 2388-7171 / (852) 2710-8012		
E-mail	acme@acmesanitary.com.hk		
Website	www.acmesanitary.com.hk		

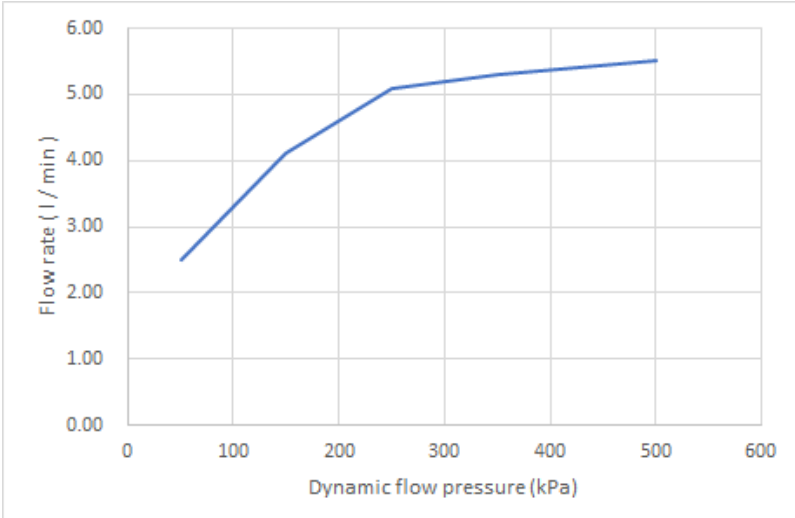

Dynamic flow pressure (kPa)	50	150	250	350	500
Flow rate (l/min)	2.50	4.10	5.10	5.30	5.50

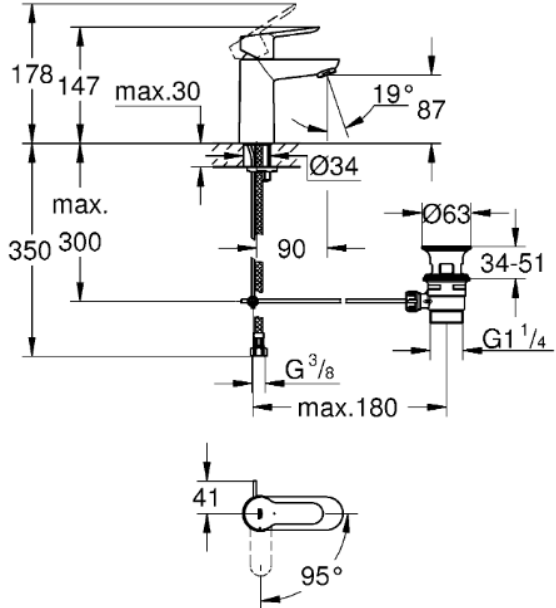

Note:

* All information of the above is for the reference only. No prior notice is made if any changes.

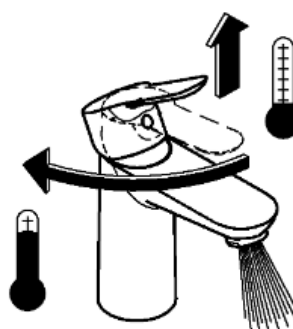
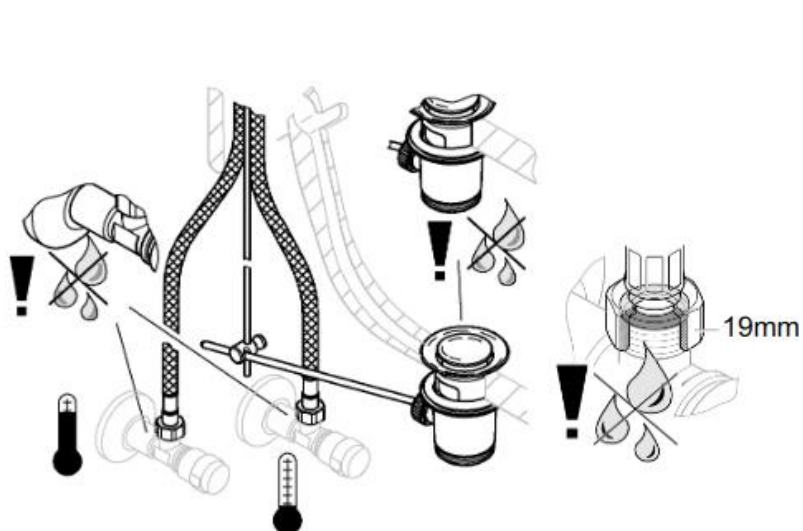
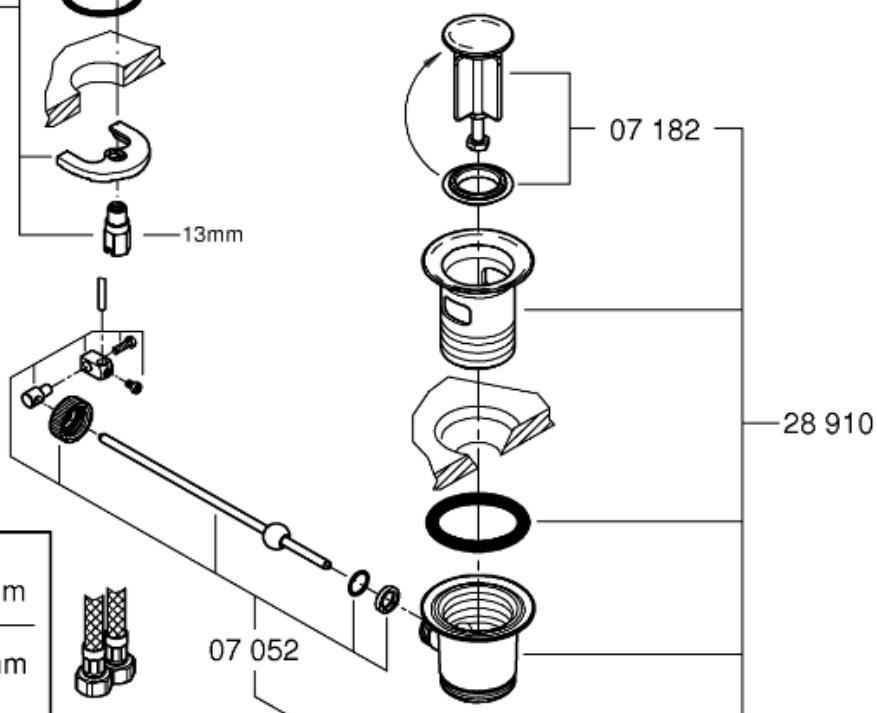
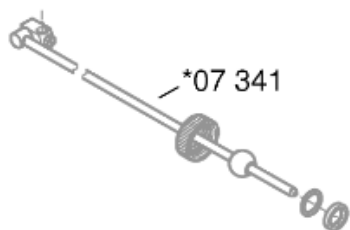
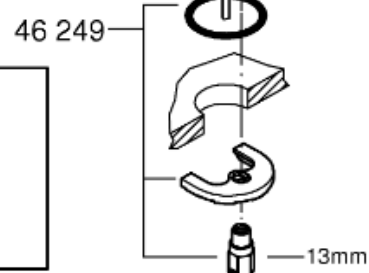
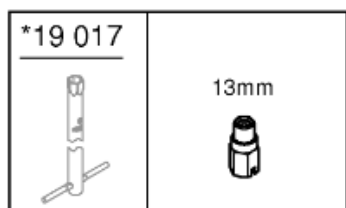
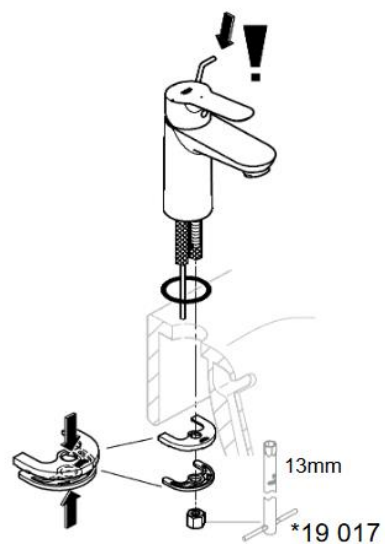
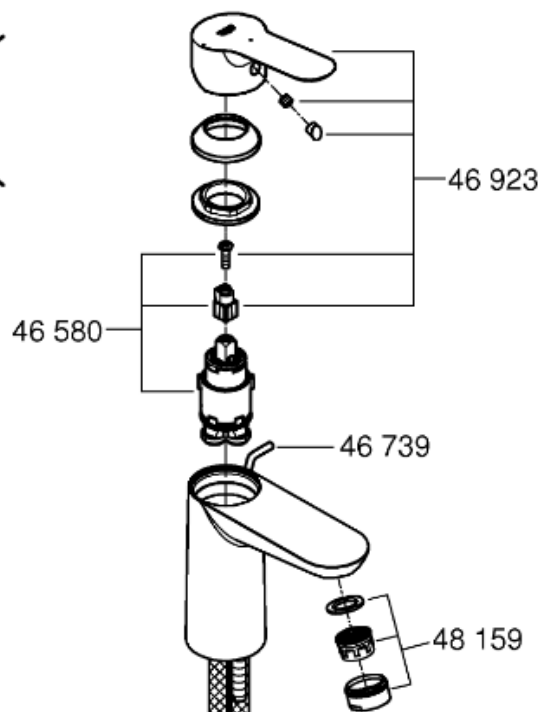
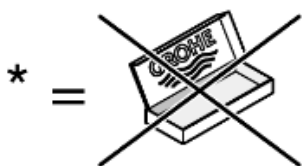



自願參與用水效益標籤計劃 - 水龍頭
Voluntary Water Efficiency Labelling Scheme - Water Taps



茲證明

This is to certify that

將下列水龍頭在本計劃內註冊：
has registered the following water tap under this scheme :

牌 子 / Brand	:	GROHE
型 號 / Model	:	23559000
種 類 / Type	:	Mixing
原產地 / Country or Region Origin	:	Thailand

在用水效益標籤上展示的標誌

Symbolic Presentation on the Water Efficiency Label :



滴水點

Water droplet(s)

用水效益級別

Water Efficiency Grade :

1

耗水量

Water Consumption :

4.8

公升/分鐘

litres/minute

簽發日期：
Date of Issue: 4 December 2017



水務署
Water Supplies Department



水務署署長(周世威代行)
for Director of Water Supplies



nent

香港入境事務大樓
Immigration and Customs District Office, Gloucester Road, Hong Kong

電子郵遞
e-mail wsdinfo@wsd.gov.hk

電話
Telephone 2829 4355

圖文傳真
Facsimile 2824 0578

檔號
Reference (4) in WSD 3321/17 Pt.1 T/J(1298)

8 November 2017

Dear Sir,

Approval of "GROHE" Basin Mixer

Your letters ref. WRC/1497 dated 27 September 2017 and ref. C-WSD/0301 dated 16 October 2017 refer.

Having considered the test report ref. J21895Ar1 issued on 10 October 2017 by Nutek Systems (HK) Ltd., this Authority accepts that the fitting described below complies with, and its use when correctly installed does not contravene, the Waterworks Ordinance and Regulations.

Name of Manufacturer: Grohe AG

Country of Origin: Thailand

Brand: Grohe

Details of Fitting: 3/8" Single lever basin mixer supplied with one pair of stainless steel wire braided water inlet flexible hose (manufactured by Neoperl GmbH. Model: Neoflex SPX DN6 G3/8") approved by UK's WRAS under ref. 1506306

Model: 23559000

Body Markings:



Expiry Date:

24 August 2022 (for mixer)
30 June 2020 (for hose)

This Authority hereby permits the use of the above fitting in fresh water plumbing systems subject to full adherence to Waterworks installation requirements. In particular, you are required to draw your customers' attention to the following requirement-

"The cold water supply to the fitting shall be drawn from the same source that supplies the hot water apparatus so as to provide a balanced pressure and to obviate the risk of scalding in the event of a restriction or failure in the water supply."

A condition of this acceptance is that the fitting to be installed shall be replicas of the sample as certified by the testing agent mentioned above and without modifications. This acceptance may be withdrawn at any time if the standard of the fitting installed fails to meet that of the approved sample or if the fitting is found to be unsuitable for use in fresh water plumbing systems.

This acceptance is only applicable to the main body of the fitting, unless other specified.

For the use of the fitting in any project, the Acceptance Reference Number at the bottom of this letter must be quoted as a means of identification of acceptance of the fitting by this Authority.

Should you have any enquiries, please contact our Engineer Mr. Terry KUNG at tel. no. 2294 2656.

Yours faithfully,

A handwritten signature in dark ink, appearing to read "Chan Chung Kun".

(CHAN Chung Kun)
for Water Authority

c.c. WSD 3321/1/82] - without catalogue
ME/MC] - with soft copy only